

# ProHD

## DT-N21H

### 21.5" Broadcast Studio LCD Monitor



## FEATURES

### Supports 3G/HD/SD-SDI and 2K-SDI

DT-N21H supports 3G-SDI (SMPTE 425M) Level-A & B, 2K-SDI (SMPTE 2048-2) 60p Level-A & B display.

### Full HD LCD panel with LED backlighting

The monitor features a 1920×1080 pixel full HD resolution LCD panel with LED backlighting, with 178° wide viewing angle (H & V), 1000:1 contrast, and 16.7M color depth.

### ITU-709 color space

The DT-N21H is compatible with ITU-709 standard color space for HDTV broadcasting.

### Selectable gamma preset

The DT-N21H supports gamma preset selection from: 2.2, 2.4 and 2.6.

### Audio meters display

The DT-N21H supports SDI/HDMI embedded audio 2-ch meters display, and analog audio 2-ch meters display.

### TSL UMD control and display

The DT-N21H monitor supports UMD controlling input via RS485 and RS232 port, compatible with TSL 3.1 and 4.0 UMD protocol.

### USB firmware upgradable

The Monitor offers a USB port on the rear side, for firmware upgrade. Users can download firmware to a USB disk, and the upgrade operation is directly on the monitor, without PC or other adaptors.

### Other features

- SDI Timecode (LTC, VITC1&2) and AFD info display
- R/G/B/Mono, False color, Zebra stripes display
- Peaking focus assist display mode
- H/V delay, freeze frame display mode
- Safety area selection: 80%, 85%, 90%, 93%, 95%
- Scale marker: 4:3, 13:9, 14:9, 15:9, 1.85:1, 2.35:1
- Native scan, over scan and normal scan selection
- GPI control via RS485 port connection
- 3 User setting data storage
- TALLY light with adjustable brightness
- 4 User definable function keys
- Easy One-key Menu operation
- Built-in speaker (2.5W, 8Ω)
- AntonBauer battery plate for field application (V-mount plate in an option)



### Rear Terminals

- RS-485 ×2.....UMD input and output
- RS-485 ×1.....GPI input
- BNC ×3.....Y/Pb/Pr input
- BNC ×2.....CVBS input and loop output
- RS-232C ×1.....UMD input
- VGA ×1.....VGA input
- HDMI-A ×2.....HDMI input and loop output
- BNC ×2.....SDI 1 input and loop output
- BNC ×2.....SDI 2 input and loop output
- RCA ×2.....Analog audio L and R input
- USB ×1.....USB firmware upgrade

## DT-N21H

21.5" Broadcast Studio LCD Monitor



### Specifications

| LCD Display            |                            | Compatible video formats |  |   |
|------------------------|----------------------------|--------------------------|--|---|
| Size                   | 21.5 inches wide format    | CVBS                     | NTSC / PAL   |   |
| Display area           | 477mm×268mm                | Y/Pb/Pr                  | 480i, 480p, 576i, 576p, 720p (50 / 60), 1080i (50 / 60)                        |   |
| Resolution             | 1920×1080 (Full HD)        | HDMI                     | 480i / 576i / 480p / 576p  |   |
| Color depth            | 16.77 million              |                          | 1080i (60 / 59.94 / 50)  |   |
| Aspect ratio           | 16:9                       |                          | 720p (60 / 59.94 / 50)   |   |
| Brightness             | 250cd/m <sup>2</sup>       |                          | 1080p (60 / 59.94 / 50 / 30 / 29.97 / 25 / 24 / 23.98)                         |   |
| Contrast               | 1000:1                     | SDI                      | 1080psf (30 / 29.97 / 25 / 24 / 23.98)   |   |
| Viewing Angle          | 178°(H) / 178°(V)          |                          | SMPTE-2048-2   | 2048×1080p (23.98 / 24 / 25 / 29.97 / 30 / 50 / 59.94 / 60) |
| Surface treatment      | Non-glass                  |                          |  | 2048×1080i (50 / 59.94 / 60)                                |
| Backlighting           | LED                        |                          | SMPTE-425M   | 1080p (60 / 59.94 / 50)                                     |
| Working voltage        | DC / battery 11V-17V       |                          | SMPTE-274M   | 1080i (60 / 59.94 / 50)                                     |
| Power consumption      | Max 32W                    |                          |  | 1080p (30 / 29.97 / 25 / 24 / 23.98)                        |
| Working temperature    | 0°C - +40°C                | SMPTE-RP211              | 1080psf (30 / 29.97 / 25 / 24 / 23.98)   |   |
| Working humidity       | 10% - 90%                  | SMPTE-296M               | 720p (60 / 59.94 / 50)   |   |
| Storage temperature    | - 15°C - + 60°C            | SMPTE-125M               | 480i (59.94)   |   |
| Storage humidity       | 10% - 90%                  | ITU-R BT.656             | 576i (50)  |   |
| VESA standard          | 100mm×100mm (M4×4mm screw) | VGA                      | 640×480, 800×600, 1024×768, 1152×864, 1280×768, 1280×960, 1280×1024, 1600×1200 |   |
| Dimensions             | 525×358×87mm               |                          |  |   |
| Net weight (w/o stand) | 6.2 Kg                     |                          |  |   |

### External dimensions

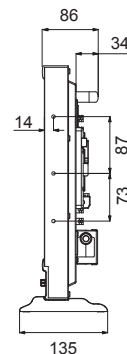
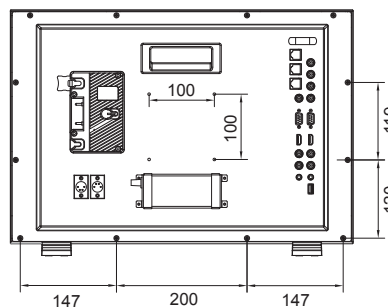
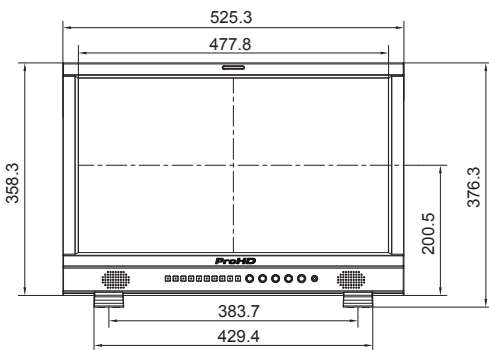

### Package



## JVCKENWOOD

E. & O.E. Design and specifications subject to change without notice  
 Copyright 2016, JVCKENWOOD Corporation. All Rights Reserved.  
 Manufactured by SWIT Electronics Co., Ltd.